

SHAD

BENELLI BN251 '17 KIT TOP BOBN27ST

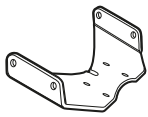

1 262066 x1



2 262067 x1
262068 x1



3 303017 x4
Ø6



4 304071 x4
M6 x 50
DIN 912



5 261042 x4
Ø16 Ø9 x 15



6 304028 x2
M8 x 25
Din 7380



7 304053 x4
M8 x 30
Din 7380



8 303045 x12
Ø8



9 302024 x6
M8

! WARNING!

(GB)

Do not fully tighten the screws until it is ensured that the KIT is correctly attached and aligned.

(E)

No apretar los tornillos del todo hasta asegurarse que el KIT está correctamente colocado y alineado.

(D)

Ziehen Sie die Schrauben nicht ganz fest, bevor Sie sich nicht vergewissert haben, daß der Bausatz korrekt eingestellt und ausgerichtet ist.

(I)

Non stringere del tutto le viti fin tanto non si è sicuri che il kit è collocato correttamente e allineato.

(F)

Ne pas serrer les vis avant d'être sûr que le KIT est correctement monté et ajusté.

ATTENTION: For a full equip assembly, mount the 3p system after the top master.

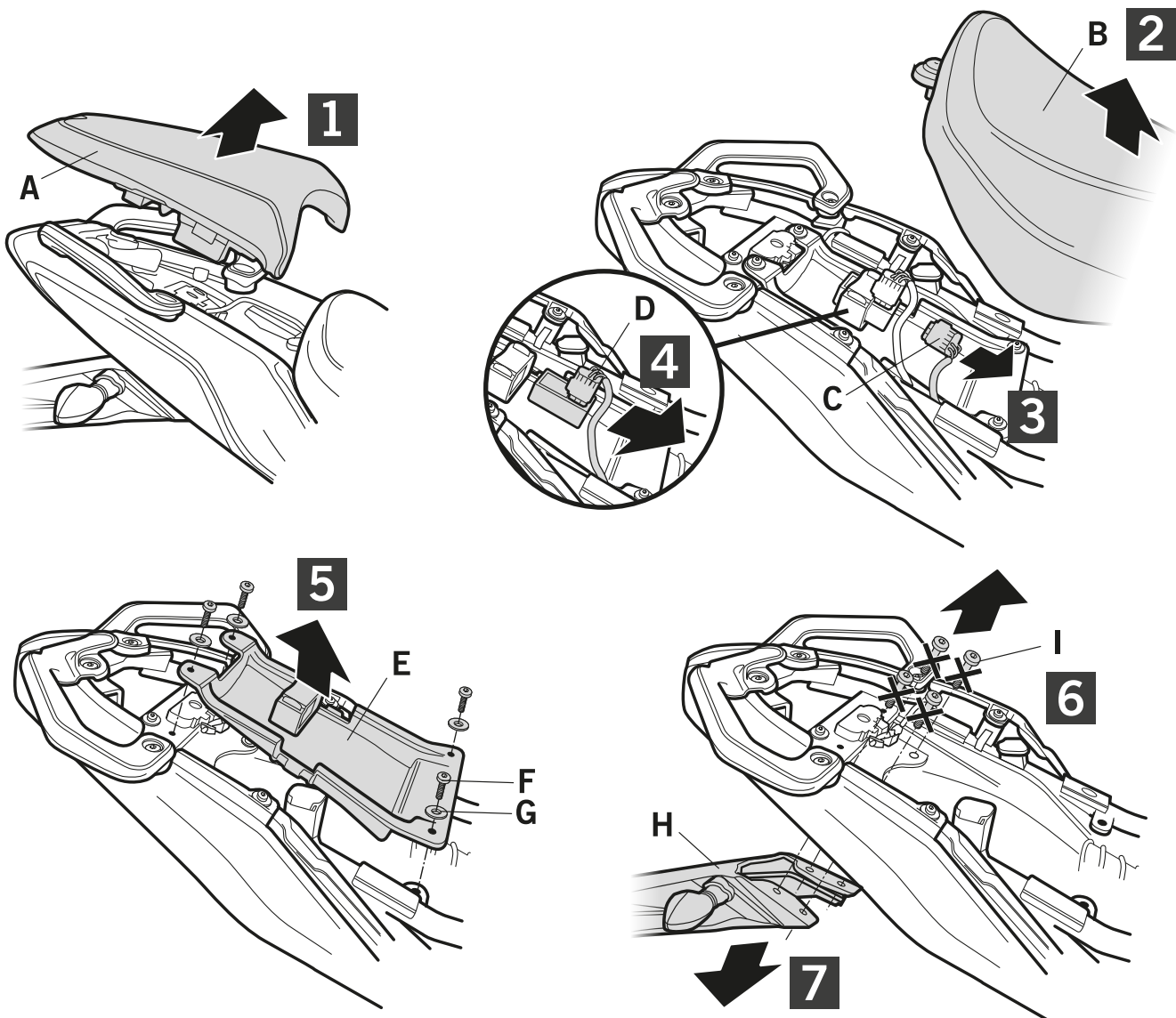

IMPORTANT: Based on European models. For compatibility with models in other continents, check www.shad.es

